

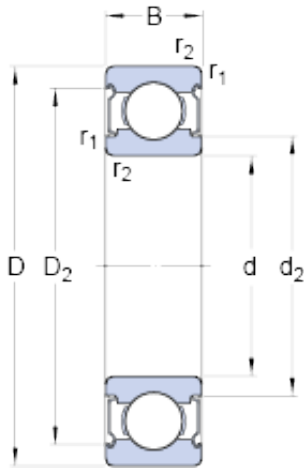

## Bearing Driveshaft do Brasil



W 638-2Z Bearing 2D drawings and 3D CAD models

8 mm x 28 mm x 9 mm SKF W 638-2Z deep groove ball bearings

Bearing No. W 638-2Z

Size	28x8x9 mm
Bore Diameter	28 mm
Outer Diameter	8 mm
Width	9 mm
d	8 mm
D	28 mm
B	9 mm
d <sub>2</sub>	13.9 mm
D <sub>2</sub>	22.38 mm
r <sub>1,2</sub> - min.	0.3 mm
d <sub>a</sub> - min.	10 mm
d <sub>a</sub> - max.	13.8 mm
D <sub>a</sub> - max.	26 mm
r <sub>a</sub> - max.	0.3 mm
Basic dynamic load rating - C	4 kN
Basic static load rating - C <sub>0</sub>	2 kN
Fatigue load limit - P <sub>u</sub>	0.083 kN
Reference speed	67000 r/min
Limiting speed	32000 r/min
Calculation factor - k <sub>r</sub>	0.035
Calculation factor - f <sub>0</sub>	12.4
d <sub>2</sub>	13.9 mm
D <sub>2</sub>	22.38 mm
r <sub>1,2</sub> min.	0.3 mm



## Bearing Driveshaft do Brasil

$d_a$ min.	10 mm
$d_a$ max.	13.8 mm
$D_a$ max.	26 mm
$r_a$ max.	0.3 mm
Basic dynamic load rating C	3.97 kN
Basic static load rating $C_0$	1.96 kN
Fatigue load limit $P_u$	0.083 kN
Calculation factor $k_r$	0.035
Calculation factor $f_0$	12.4
Mass bearing	0.028 kg